

SUMMER DEALS

FREE GOODS WITH
PURCHASE OF SELECT

BARE TOOLS

CONTACT YOUR LOCAL SALES REP FOR FULL LIST OF ELIGIBLE SKUS. WHILE SUPPLIES LAST. FREE GOOD TIERS ARE NON-STACKABLE. ONLY THE HIGHEST TIER WILL BE AWARDED FOR QUALIFYING PURCHASES.

TIER 1: BUY 1 TOOL

GET **THIS** 5.0Ah
BATTERY
FREE

DCB205PROMO
20V MAX 5.0Ah Battery

\$169 VALUE



TIER 2: BUY 2 TOOLS

GET **THIS** STARTER
KIT
FREE

DCB205-2CPROMO
20V MAX 5.0Ah
Battery
Kit

\$299 VALUE



TIER 3: BUY 4 TOOLS

GET **2 FREE** STARTER KITS **PLUS**
A BONUS LIGHT

TOTAL VALUE \$749

DCL077BPROMO
12V/20V MAX
Compact
Task Light



DCB205-2CPROMO
20V MAX 5.0Ah Battery Kits (2)



DCD1007B
20V MAX XR®
Brushless
Cordless
1/2" 3-Speed
Hammer
Drill

\$249



DCH273B
20V MAX XR® SDS PLUS
Brushless
1" L-Shape
Rotary Hammer

\$349



DCF845B
20V MAX
XR® 1/4" 3-Speed
Impact
Driver

\$179

DCS378B
20V MAX XR®
Mid-Size
Band Saw

\$349

DCL079B
20V MAX
Cordless
Tripod Light
Bare Tool

\$249

DCS356B
20V
MAX
XR® Brushless Cordless
3-Speed Oscillating
Multi-Tool

\$199



DCV581H
20V MAX Cordless/Corded
Wet-Dry
Vacuum

\$199

DCB104
12V MAX/20V MAX/ FLEXVOLT®
8 Amp Fan Cooled
Multiport Fast Charger

\$329

BUY 1 OF THESE FLEXVOLT® BARE TOOLS

DCS578B
60V MAX 7-1/4"
Brushless
Circular Saw with
Electronic
Brake

\$299



DCS577B
FLEXVOLT®
60V MAX
7-1/4"
Cordless
Worm Drive Style Saw

\$299



DCS389B
60V MAX Brushless
Cordless Reciprocating Saw

\$299



DCG418B
60V MAX
Brushless
Cordless 4-1/2" - 6"
Grinder with KICKBACK BRAKE™

\$279



GET **THIS** 9.0Ah
BATTERY **FREE**

DCB609PROMO
20V/60V MAX
FLEXVOLT® 9.0Ah Battery

\$249 VALUE



GET \$100 OFF
THIS
COMBO KIT



DCK2100P2
20V MAX Hammer Drill
and 20V MAX Impact
Driver with FLEXVOLT
ADVANTAGE™ Combo Kit
\$399 - \$100 = \$299

NEW LOWER
PRICE
SMALL ANGLE
GRINDER



DWE402N
4-1/2" (115mm) Small
Angle Grinder
with No Lock-On

\$89



SCAN HERE
TO SHOP
THESE
DEALS
NOW

**FREE GOODS
WITH PURCHASE**

DEWALT® ANCHORS

**ANY
MIX**

DEWALT FASTENERS QUALIFY TOWARDS PROMOTIONAL THRESHOLDS FOR THE STATE OF COLORADO. NON-STOCKED ITEMS MAY BE ORDERED AND ARE ELIGIBLE FOR THIS OFFER. MAXIMUM \$6000 ORDER THRESHOLD PER CUSTOMER. FREE GOOD TIER IS NON-STOCKABLE. ONLY THE HIGHEST TIER WILL BE AWARDED FOR QUALIFYING PURCHASES.

TIER 1: SPEND \$1500

GET **THIS**
IMPACT
DRIVER
KIT **FREE**

DCF845P2PROMO
20V MAX XR®
3-Speed 1/4"
Impact Driver Kit



\$299 VALUE

TIER 2: SPEND \$3000

GET **THIS** ROTARY
HAMMER
KIT **FREE**

DCH273P2DHOPROMO
20V MAX XR® L-Shape
1" SDS Plus Rotary Hammer
Kit with Onboard
Dust Extractor



\$769 VALUE

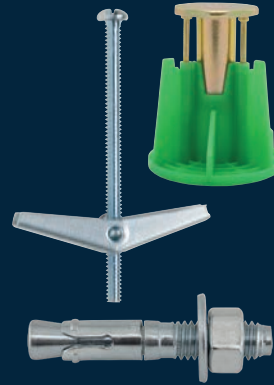

BUY 1 20V SINGLE KIT

CONTACT YOUR LOCAL SALES REP FOR FULL LIST
OF ELIGIBLE SKUS. WHILE SUPPLIES LAST.

DCF921P2
ATOMIC™ 20V MAX
1/2" Cordless
Impact Wrench
Kit with Hog
Ring
Anvil **\$469**



DCS356D1
20V MAX XR®
Brushless Cordless 3-Speed
Oscillating
Multi-Tool Kit **\$259**



DCF923P2
ATOMIC™ 20V MAX 3/8" Cordless
Impact Wrench
Kit with Hog
Ring Anvil **\$469**



DCS378P1
20V MAX XR®
Mid-Size
Band Saw
(5.0Ah
Battery Kit) **\$519**



GET **THIS** 5.0Ah BATTERY
OR IMPACT DRIVER **FREE**

DCB205PROMO
20V MAX 5.0Ah Battery
\$169 VALUE



DCF845B
PROMO
20V MAX XR®
1/4" 3-Speed
Impact Driver
\$169 VALUE



BUY 1 OF THESE MEP KITS OR TOOLS

DCS350D1
20V MAX
Threaded Rod
Cutter Kit **\$479**



DCE151TD1
20V MAX XR®
Cordless Cable
Stripper Kit **\$549**



DCE154B
20V MAX
XR® 1-1/4"
Copper Tubing
Cutter **\$219**



DCE158D1
20V MAX XR® Brushless Cordless
Wire Mesh Cable Tray Cutter Kit **\$899**



GET **THIS**
2.0Ah
BATTERY **FREE**

DCB203
PROMO
20V MAX
2Ah Battery
\$119 VALUE



BUY 1 OF THESE LIGHTS

GET 1 OF THE
SAME
FREE

DCL040
20V MAX
LED Work
Light Bare Tool
\$84



DCL040PROMO

DCL050
20V MAX LED
Handheld
Area Light
Bare Tool
\$89



DCL050PROMO

DENVER, COLORADO
303.595.8488

GREELEY, COLORADO
970.352.8585

INDIANAPOLIS, INDIANA
317.876.8800

DES MOINES, IOWA
515.244.1516

KANSAS CITY, KANSAS
913.722.7879

LOUISVILLE, KENTUCKY
502.635.6348

HIBBING, MINNESOTA
218.263.8687

ST. PAUL, MINNESOTA
651.646.4055

LINCOLN, NEBRASKA
402.476.6673

OMAHA, NEBRASKA
402.592.7385

APPLETON, WISCONSIN
920.687.4061

MILWAUKEE, WISCONSIN
262.547.5548

SUPERIOR, WISCONSIN
715.392.2294

WAUSAU, WISCONSIN
715.848.2703

